

400 SERIES HEAVY DUTY STRAIGHT TRACK

COMPLETE TRACK MODEL NUMBERS

- 401A 401S
- 416A 416S 416P
- 418A 418S 418P
- 428A 428S

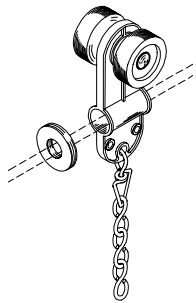
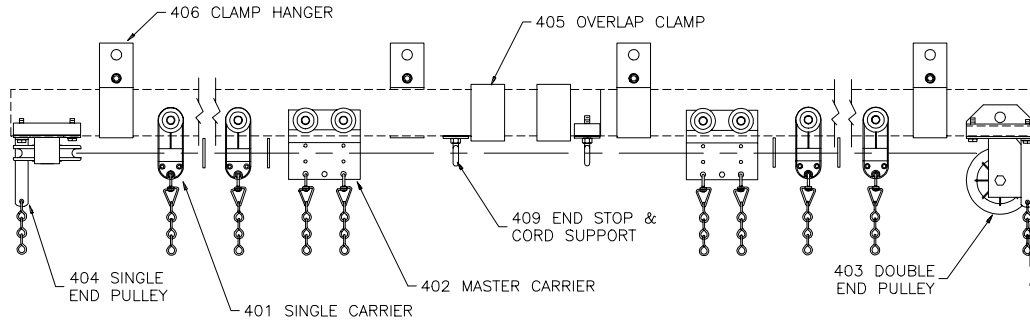

No. 401 SINGLE CARRIER

2 polyethylene wheels riveted to black Super Tough nylon body with shielded ball bearing. Heavy duty hook, swivel, and trim chain for curtain attachment. Supplied with 1 rubber bumper.

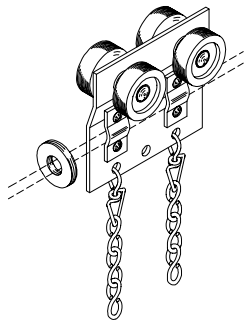

No. 402 MASTER CARRIER

4 polyethylene wheels riveted to steel body with 2 shielded ball bearings. 2 clamps provided for anchoring line or cable. Supplied with 1 rubber bumper. 1 pair required for overlapping tracks.

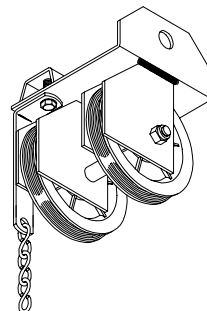

No. 403 DOUBLE END PULLEY

4" diameter Nylatron GS sheaves with shielded ball bearings. Steel housing clamps to underside of track. Chain bracket for securing offstage curtain edge.



No. 404 SINGLE END PULLEY

4" diameter Nylatron GS sheave with shielded ball bearing. Steel housing clamps to underside of track. Chain bracket for securing offstage curtain edge.

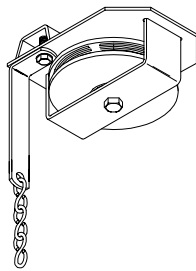

No. 404S SINGLE END PULLEY

4" diameter steel sheave with sealed precision ball bearings. Steel housing clamps to underside of track. Chain bracket for securing offstage curtain edge.

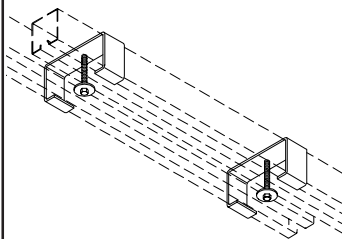

No. 405 OVERLAP CLAMP

Formed steel clamps to align track at overlap. 1 set pictured.

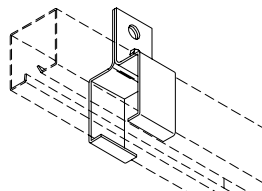

No. 406 CLAMP HANGER

Formed steel brackets clamp to track. Adjusts to any position. Suspend track with welded chain or wire rope. 1 pair pictured.

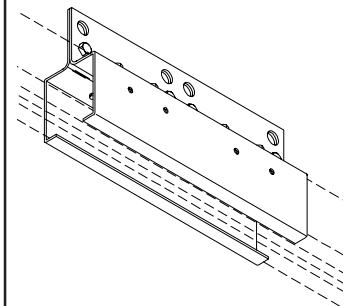

No. 407 SPLICE

Formed steel brackets align and lock track sections together. 1 pair pictured.

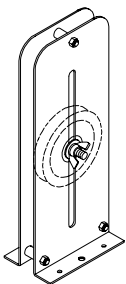

No. 408 ADJUSTABLE FLOOR BLOCK

4" diameter Nylatron GS sheave with shielded ball bearing in steel housing. 9" vertical adjustment.

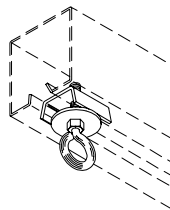

No. 409 END STOP & CORD SUPPORT

Steel clamp with eye to support operating line and prevent carriers from travelling beyond desired location. 1 pair required for overlapping tracks.

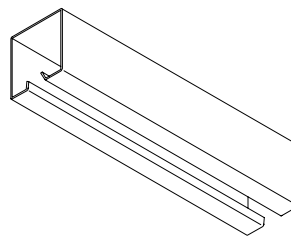

No. 410A TRACK

6063-T5 extruded aluminum .080" thick. 20" and 24" stock lengths.

No. 410S TRACK

14 gauge galvanized steel roll-formed to 2-5/8" wide x 2-3/4" high. 16", 20", 24" and 26" stock lengths.

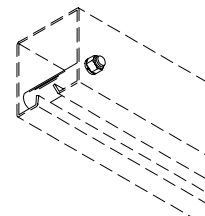

No. 411 END STOP

Bolt with steel spacer to prevent carriers from travelling beyond desired location.

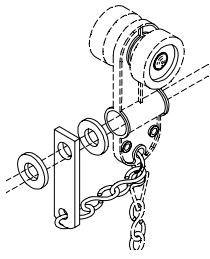

REAR FOLD GUIDE

Allows curtain to fold at offstage edges. Supplied with 1 rubber bumper.

- No. 412 - for use with 3/8" operating line.
- No. 412A - for use with 1/2" operating line.
- No. 413 - for use with 3/16" operating cable.

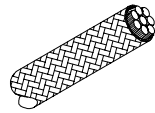

No. 414 OPERATING LINE

3/8" diameter black polyester double braided over solid polyester core for manual operation.

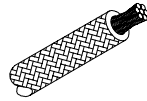

No. 415 OPERATING CABLE

3/16" diameter black polyester jacket braided over 3/32" galvanized aircraft cable for motor operation.

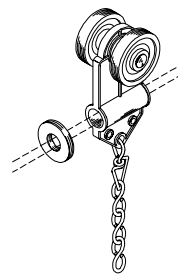

No. 416 SINGLE CARRIER

2 nylon-tired ball bearing wheels riveted to black Super Tough nylon body with heavy duty hook, swivel and trim chain for curtain attachment. Supplied with 1 rubber bumper.

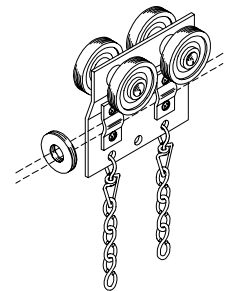

No. 417 MASTER CARRIER

4 nylon-tired ball bearing wheels riveted to steel body. 2 clamps provided for anchoring line or cable. Supplied with 1 rubber bumper. 1 pair required for overlapping tracks.

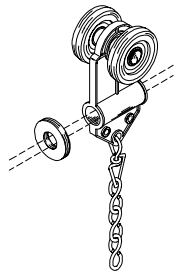

No. 418 SINGLE CARRIER

2 neoprene-tired ball bearing wheels riveted to black Super Tough nylon body with heavy duty hook, swivel and trim chain for curtain attachment. Supplied with 1 rubber bumper.

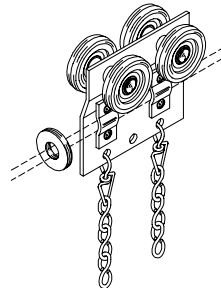

No. 419 MASTER CARRIER

4 neoprene-tired ball bearing wheels riveted to steel body. 2 clamps provided for anchoring line or cable. Supplied with 1 rubber bumper. 1 pair required for overlapping tracks.

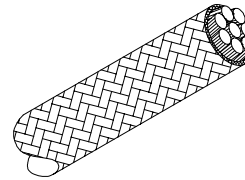

No. 420 OPERATING LINE

1/2" diameter black polyester double braided over solid polyester core for manual operation.

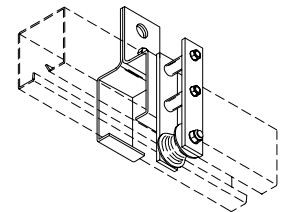

No. 421 CLAMP HANGER WITH IDLER

No. 406 clamp hanger with Nylatron ball bearing roller for supporting operating line or cable.

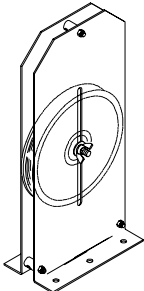

No. 422, 8" ADJUSTABLE FLOOR BLOCK

8" diameter Nylatron GS sheave with sealed precision ball bearings in heavy duty steel housing with 9" vertical adjustment. Grooved to accept up to 1/2" operating line.

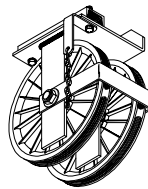

8" DOUBLE END PULLEY

8" diameter Nylatron GS sheaves with sealed precision ball bearings. Heavy duty steel housing clamps to underside of track. Chain bracket for securing off-stage curtain edge.

- No. 423 - Grooved for up to 1/2" operating line.
- No. 423M - Grooved for 3/16" operating cable.

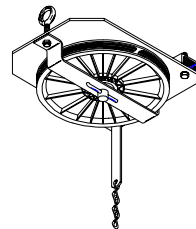

8" SINGLE END PULLEY

8" diameter Nylatron GS sheave with sealed precision ball bearings. Heavy duty steel housing clamps to underside of track. Chain bracket for securing off-stage curtain edge.

- No. 424 - Grooved for up to 1/2" operating line.
- No. 424M - Grooved for 3/16" operating cable.

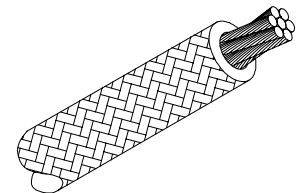

No. 425 OPERATING CABLE

3/8" black polyester double braided over solid polyester core reinforced with 3/32" galvanized aircraft cable. Extremely stretch resistant for heavy manual operation.

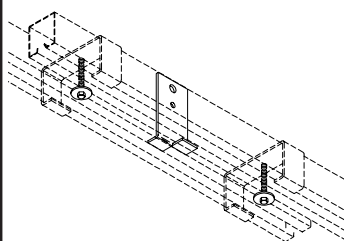

No. 426 CENTER PIPE SUPPORT

Formed steel bracket used to support tracks at overlap.

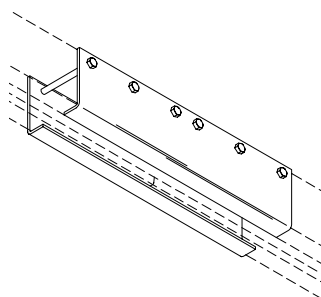

No. 427 CEILING SPLICE

To align and lock track sections together on ceiling mounted tracks. 1 pair pictured.

Note: Cannot be used with No. 40 pivot device.

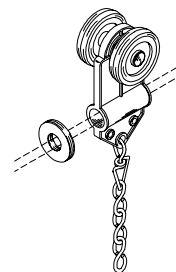

No. 428 SINGLE CARRIER

2 neoprene-tired wheels riveted to black Super Tough nylon body with shielded ball bearing. Heavy duty hook, swivel and trim chain for curtain attachment. Supplied with 1 rubber bumper.

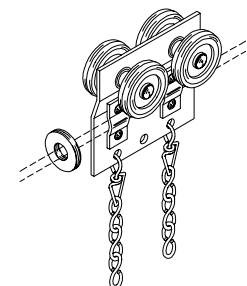

NO. 429 MASTER CARRIER

4 neoprene-tired wheels riveted to steel body with 2 shielded ball bearings. 2 clamps provided for anchoring line or cable. Supplied with 1 rubber bumper. 1 pair required for overlapping tracks.

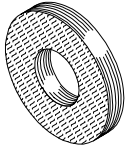

ROUND RUBBER BUMPER

1/8" neoprene bumper placed between carriers to reduce noise.

- No. 430 - for use with 3/16" operating cable.
- No. 431 - for use with 3/8" operating line.
- No. 431A - for use with 1/2" operating line.

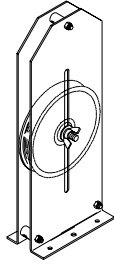

No. 432, 6" ADJUSTABLE FLOOR BLOCK

6" diameter Nylatron GS sheave with sealed precision ball bearings in heavy duty steel housing with 9" vertical adjustment. Grooved to accept up to 1/2" operating line.

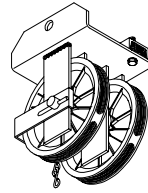

6" DOUBLE END PULLEY

6" diameter Nylatron GS sheaves with precision sealed ball bearings. Heavy duty steel housing clamps to underside of track. Chain bracket for securing off-stage curtain edge.

- No. 433 - Grooved for up to 1/2" operating line.
- No. 433M - Grooved for 3/16" operating cable.

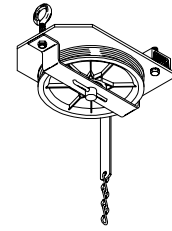

6" SINGLE END PULLEY

6" diameter Nylatron GS sheave with sealed precision ball bearings. Heavy duty steel housing clamps to underside of track. Chain bracket for securing off-stage curtain edge.

- No. 434 - Grooved for up to 1/2" operating line.
- No. 434M - Grooved for 3/16" operating cable.

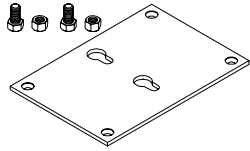

DETACHABLE FLOOR BLOCK KIT

7 gauge steel plate with hardware for use with floor block for quick release.

- No. 408DK - use with No. 408 4" Floor Block.
- No. 422DK - use with No. 422 8" Floor Block.
- No. 432DK - use with No. 432 6" Floor Block.

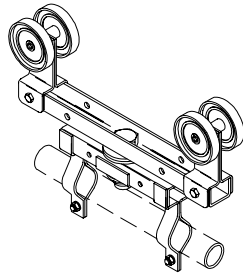

No. 40 PIVOT DEVICE

Heavy steel construction with nylon wheels. Supplied with brackets for 1-3/8" O.D. pipe or tubing (recommended 6 foot maximum length). Allows masking draperies to be rotated to any angle. Working load limit: 75 pounds.

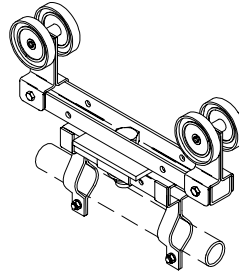

No. 40X INDEXING PIVOT DEVICE

Pivot device with special plate to index rotation at 22-1/2 degree increments. Supplied with brackets for 1-3/8" O.D. pipe or tubing (recommended 6 foot maximum length). Working load limit: 75 pounds.

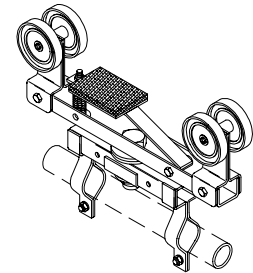

No. 40BK BRAKE KIT

Spring loaded arm with neoprene pad. Add to pivot device to prevent undesired movement along track.

400 SERIES COMPLETE TRACK COMPONENT GUIDE

PART #	DESCRIPTION	401S	416S	416P	418S	418P	428S
401	Single Carrier	•					
402	Master Carrier	•					
403	4" Double End Pulley	•					
404	4" Single End Pulley	•					
405	Overlap Clamp	•	•	•	•	•	•
406	Clamp Hanger	•	•	•	•	•	•
407*	Splice	•	•	•	•	•	•
408	4" Adjustable Floor Block	•					
409	End Stop & Cord Support	•	•	•	•	•	•
410S*	Track	•	•	•	•	•	•
412A	1/2" Rear Fold Guide			•		•	
414	3/8" Operating Line	•			•		•
416	Nylon B.B. Single Carrier		•	•			
417	Nylon B.B. Master Carrier		•	•			
418	Neoprene B.B. Single Carrier				•	•	
419	Neoprene B.B. Master Carrier				•	•	
420	1/2" Operating Line			•		•	
422	8" Adjustable Floor Block					•	
423	8" Double End Pulley			•		•	
424	8" Single End Pulley			•		•	
428	Neoprene Single Carrier						•
429	Neoprene Master Carrier						•
432	6" Adjustable Floor Block		•		•		•
433	6" Double End Pulley		•		•		•
434	6" Single End Pulley		•		•		•

* Track lengths and splices supplied as required from stock sizes.

For COMPLETE tracks with aluminum channel, substitute 410A for 410S.

GENERAL SPECIFICATIONS: HEAVY DUTY STRAIGHT TRACK

Provide **Model 401S** as manufactured by H & H Specialties Inc., South El Monte, CA.

Track shall be 14 gauge galvanized steel, roll-formed to 2-5/8" wide X 2-3/4" high channel with continuous slot in bottom. Provide unspliced in lengths up to 26'.

Suspend track on 7' maximum centers with two-piece clamp hanger formed from 11 gauge steel. Provide 2' overlap at center, rigidly separated by two overlap clamps. Install end stop with cord support at each track end. Where lengths exceed 26', connect tracks with 12" long, two-piece splicing clamp of 12 gauge steel.

Provide single carriers, spaced on 12" centers, constructed of two polyethylene wheels fastened parallel to carrier body. Supply with heavy duty hook, swivel eye and trim chain for attachment of curtain. Black Super Tough nylon shall be molded around shielded and greased ball bearing to form carrier body. Install round neoprene bumper between each carrier to reduce noise.

Master carriers shall be 4-wheel assemblies with bodies formed from 11 gauge steel with press-fit ball bearings. Connect to operating line with two formed steel cord clamps attached to each body. Supply each master carrier with two heavy duty hooks, swivel eyes and trim chains for attachment of leading edge of curtain.

Single and double end pulleys shall clamp securely to the underside of the track channel and shall contain 4" diameter sheaves enclosed in steel housings to prevent operating line from escaping the grooves. Sheaves shall be Nylatron GS molded around shielded and greased ball bearings and grooved to accommodate up to 3/8" operating line.

Provide floor block in 12 gauge steel housing containing 4" Nylatron GS, ball bearing sheave. Sheave axle shall lock at any point within 9" vertical slots to allow tension adjustment of operating line.

Black operating line shall be 3/8" diameter, stretch-resistant rope with spun polyester outer jacket double braided over solid polyester core. All steel components shall be zinc plated to resist corrosion.

Provide **Model 416S** as manufactured by H & H Specialties Inc., South El Monte, CA.

Track shall be 14 gauge galvanized steel, roll-formed to 2-5/8" wide X 2-3/4" high channel with continuous slot in bottom. Provide unspliced in lengths up to 26'.

Suspend track on 7' maximum centers with two-piece clamp hanger formed from 11 gauge steel. Provide 2' overlap at center, rigidly separated by two overlap clamps. Install end stop with cord support at each track end. Where lengths exceed 26', connect tracks with 12" long, two-piece splicing clamp of 12 gauge steel.

Provide single carriers, spaced on 12" centers, constructed of two nylon-tired ball bearing wheels fastened parallel to black Super Tough nylon carrier body. Supply with heavy duty hook, swivel eye and trim chain for attachment of curtain. Install round neoprene bumper between each carrier to reduce noise.

Master carriers shall be 4-wheel nylon-tired ball bearing assemblies with bodies formed from 11 gauge steel. Connect to operating line with two formed steel cord clamps attached to each body. Supply each master carrier with two heavy duty hooks, swivel eyes and trim chains for attachment of leading edge of curtain.

Single and double end pulleys shall clamp securely to the underside of the track channel and shall be equipped with 6" diameter Nylatron GS sheaves grooved for up to 1/2" operating line. Install two 5/8" sealed precision ball bearings in each sheave. Lock shaft to side plate on head end with 3/16" keeper pin to prevent rotation and install fine-threaded nylon insert lock nut.

Provide floor block in 12 gauge steel housing containing 6" Nylatron sheave with two 3/8" sealed precision ball bearings. Sheave axle shall lock at any point within 9" vertical slots to allow tension adjustment of operating line.

Black operating line shall be 3/8" diameter, stretch-resistant rope with spun polyester outer jacket double braided over solid polyester core. All steel components shall be zinc plated to resist corrosion.

Provide **Model 416P** as manufactured by H & H Specialties Inc., South El Monte, CA.

Track shall be 14 gauge galvanized steel, roll-formed to 2-5/8" wide X 2-3/4" high channel with continuous slot in bottom. Provide unspliced in lengths up to 26'.

Suspend track on 7' maximum centers with two-piece clamp hanger formed from 11 gauge steel. Provide 2' overlap at center, rigidly separated by two overlap clamps. Install end stop with cord support at each track end. Where lengths exceed 26', connect tracks with 12" long, two-piece splicing clamp of 12 gauge steel.

Provide single carriers, spaced on 12" centers, constructed of two nylon-tired ball bearing wheels fastened parallel to black Super Tough nylon carrier body. Supply with heavy duty hook, swivel eye and trim chain for attachment of curtain. Install rear fold guide and two round neoprene bumpers between each carrier to fold curtain at offstage edges and minimize noise.

Master carriers shall be 4-wheel nylon-tired ball bearing assemblies with bodies formed from 11 gauge steel. Connect to operating line with two formed steel cord clamps attached to each body. Supply each master carrier with two heavy duty hooks, swivel eyes and trim chains for attachment of leading edge of curtain.

Single and double end pulleys shall clamp securely to the underside of the track channel and shall be equipped with 8" diameter Nylatron GS sheaves grooved for 1/2" operating line. Install two 5/8" sealed precision ball bearings in each sheave. Lock shaft to side plate on head end with 3/16" keeper pin to prevent rotation and install fine-threaded nylon insert lock nut.

Provide floor block in 12 gauge steel housing containing 8" Nylatron sheave with two 3/8" sealed precision ball bearings. Sheave axle shall lock at any point within 9" vertical slots to allow tension adjustment of operating line.

Black operating line shall be 1/2" diameter, stretch-resistant rope with spun polyester outer jacket double braided over solid polyester core. All steel components shall be zinc plated to resist corrosion.

GENERAL SPECIFICATIONS: (continued) HEAVY DUTY STRAIGHT TRACK

Provide **Model 418S** as manufactured by H & H Specialties Inc., South El Monte, CA.

Track shall be 14 gauge galvanized steel, roll-formed to 2-5/8" wide X 2-3/4" high channel with continuous slot in bottom. Provide unspliced in lengths up to 26'.

Suspend track on 7' maximum centers with two-piece clamp hanger formed from 11 gauge steel. Provide 2' overlap at center, rigidly separated by two overlap clamps. Install end stop with cord support at each track end. Where lengths exceed 26', connect tracks with 12" long, two-piece splicing clamp of 12 gauge steel.

Provide single carriers, spaced on 12" centers, constructed of two neoprene-tired ball bearing wheels fastened parallel to black Super Tough nylon carrier body. Supply with heavy duty hook, swivel eye and trim chain for attachment of curtain. Install round neoprene bumper between each carrier to reduce noise.

Master carriers shall be 4-wheel neoprene-tired ball bearing assemblies with bodies formed from 11 gauge steel. Connect to operating line with two formed steel cord clamps attached to each body. Supply each master carrier with two heavy duty hooks, swivel eyes and trim chains for attachment of leading edge of curtain.

Single and double end pulleys shall clamp securely to the underside of the track channel and shall be equipped with 6" diameter Nylatron GS sheaves grooved for up to 1/2" operating line. Install two 5/8" sealed precision ball bearings in each sheave. Lock shaft to side plate on head end with 3/16" keeper pin to prevent rotation and install fine-threaded nylon insert lock nut.

Provide floor block in 12 gauge steel housing containing 6" Nylatron sheave with two 3/8" sealed precision ball bearings. Sheave axle shall lock at any point within 9" vertical slots to allow tension adjustment of operating line.

Black operating line shall be 3/8" diameter, stretch-resistant rope with spun polyester outer jacket double braided over solid polyester core.

All steel components shall be zinc plated to resist corrosion.

Provide **Model 418P** as manufactured by H & H Specialties Inc., South El Monte, CA.

Track shall be 14 gauge galvanized steel, roll-formed to 2-5/8" wide X 2-3/4" high channel with continuous slot in bottom. Provide unspliced in lengths up to 26'.

Suspend track on 7' maximum centers with two-piece clamp hanger formed from 11 gauge steel. Provide 2' overlap at center, rigidly separated by two overlap clamps. Install end stop with cord support at each track end. Where lengths exceed 26', connect tracks with 12" long, two-piece splicing clamp of 12 gauge steel.

Provide single carriers, spaced on 12" centers, constructed of two neoprene-tired ball bearing wheels fastened parallel to black Super Tough nylon carrier body. Supply with heavy duty hook, swivel eye and trim chain for attachment of curtain. Install rear fold guide and two round neoprene bumpers between each carrier to fold curtain at offstage edges and minimize noise.

Master carriers shall be 4-wheel neoprene-tired ball bearing assemblies with bodies formed from 11 gauge steel. Connect to operating line with two formed steel cord clamps attached to each body. Supply each master carrier with two heavy duty hooks, swivel eyes and trim chains for attachment of leading edge of curtain.

Single and double end pulleys shall clamp securely to the underside of the track channel and shall be equipped with 8" diameter Nylatron GS sheaves grooved for 1/2" operating line. Install two 5/8" sealed precision ball bearings in each sheave. Lock shaft to side plate on head end with 3/16" keeper pin to prevent rotation and install fine-threaded nylon insert lock nut.

Provide floor block in 12 gauge steel housing containing 8" Nylatron sheave with two 3/8" sealed precision ball bearings. Sheave axle shall lock at any point within 9" vertical slots to allow tension adjustment of operating line.

Black operating line shall be 1/2" diameter, stretch-resistant rope with spun polyester outer jacket double braided over solid polyester core.

All steel components shall be zinc plated to resist corrosion.

Provide **Model 428S** as manufactured by H & H Specialties Inc., South El Monte, CA.

Track shall be 14 gauge galvanized steel, roll-formed to 2-5/8" wide X 2-3/4" high channel with continuous slot in bottom. Provide unspliced in lengths up to 26'.

Suspend track on 7' maximum centers with two-piece clamp hanger formed from 11 gauge steel. Provide 2' overlap at center, rigidly separated by two overlap clamps. Install end stop with cord support at each track end. Where lengths exceed 26', connect tracks with 12" long, two-piece splicing clamp of 12 gauge steel.

Provide single carriers, spaced on 12" centers, constructed of two neoprene-tired wheels fastened parallel to carrier body. Supply with heavy duty hook, swivel eye and trim chain for attachment of curtain. Black Super Tough nylon shall be molded around shielded and greased ball bearing to form carrier body. Install round neoprene bumper between each carrier to reduce noise.

Master carriers shall be 4-wheel neoprene-tired assemblies with bodies formed from 11 gauge steel with press-fit ball bearings. Connect to operating line with two formed steel cord clamps attached to each body. Supply each master carrier with two heavy duty hooks, swivel eyes and trim chains for attachment of leading edge of curtain.

Single and double end pulleys shall clamp securely to the underside of the track channel and shall be equipped with 6" diameter Nylatron GS sheaves grooved for up to 1/2" operating line. Install two 5/8" sealed precision ball bearings in each sheave. Lock shaft to side plate on head end with 3/16" keeper pin to prevent rotation and install fine-threaded nylon insert lock nut.

Provide floor block in 12 gauge steel housing containing 6" Nylatron sheave with two 3/8" sealed precision ball bearings. Sheave axle shall lock at any point within 9" vertical slots to allow tension adjustment of operating line.

Black operating line shall be 3/8" diameter, stretch-resistant rope with spun polyester outer jacket double braided over solid polyester core.

401S TRACK DIMENSION DETAIL

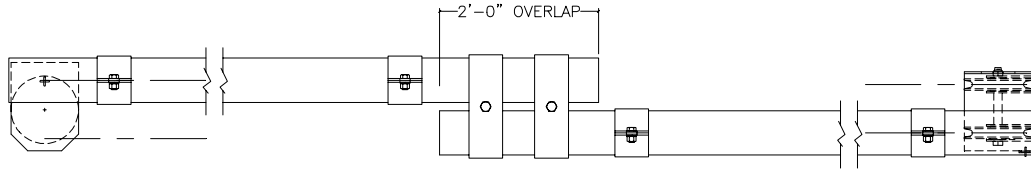

PLAN - MODEL 401S COMPLETE TRACK

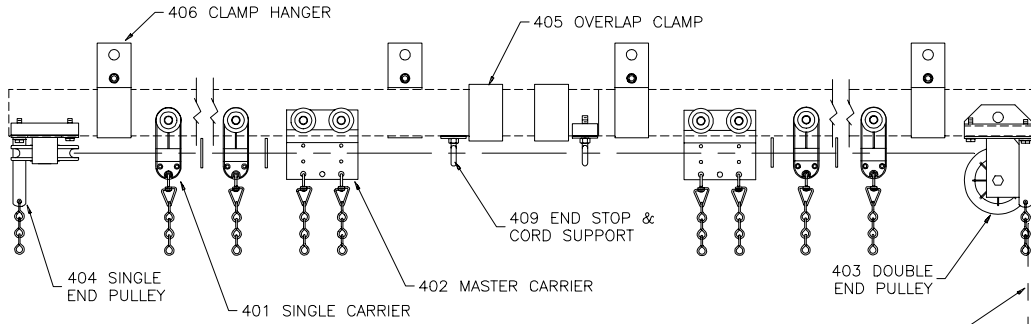

ELEVATION - MODEL 401S COMPLETE TRACK

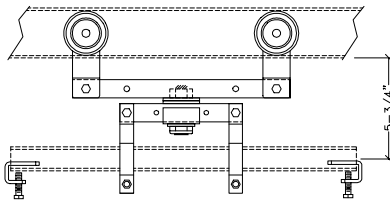

#40 PIVOT DEVICE

414 OPERATING LINE (3/8")

408 ADJUSTABLE FLOOR BLOCK

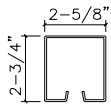

#410 TRACK

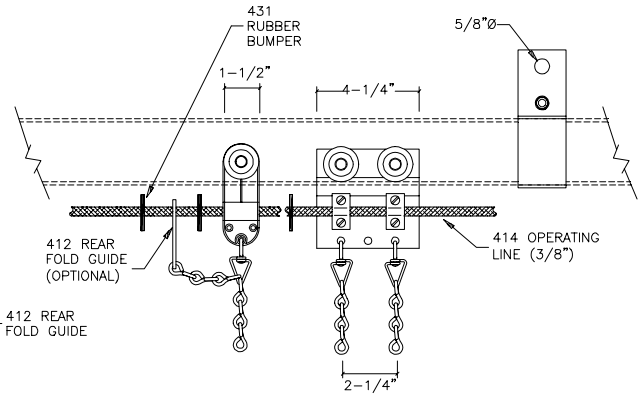
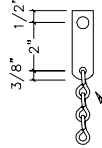
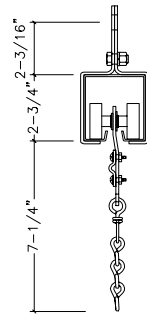
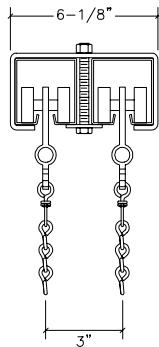

TRACKS AT CENTER OVERLAP

#401 SINGLE CARRIER AND #402 MASTER CARRIER

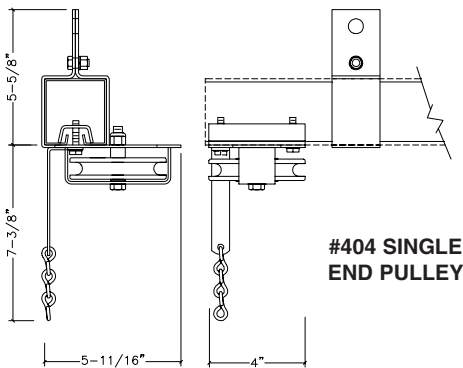

#404 SINGLE END PULLEY

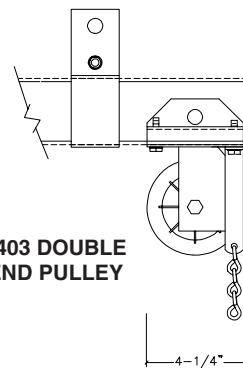

#403 DOUBLE END PULLEY

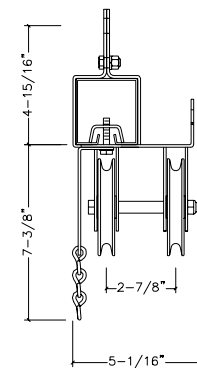

418S TRACK DIMENSION DETAIL

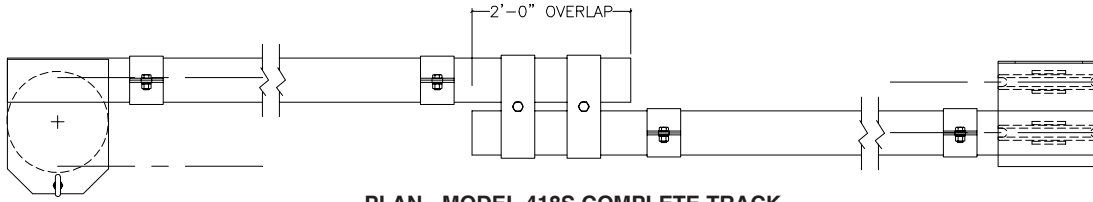

PLAN - MODEL 418S COMPLETE TRACK

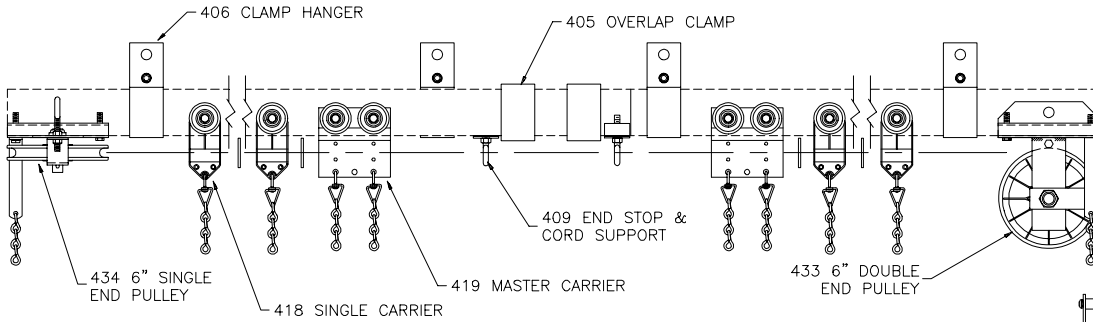

ELEVATION - MODEL 418S COMPLETE TRACK

414 OPERATING LINE (3/8")

432 ADJUSTABLE FLOOR BLOCK

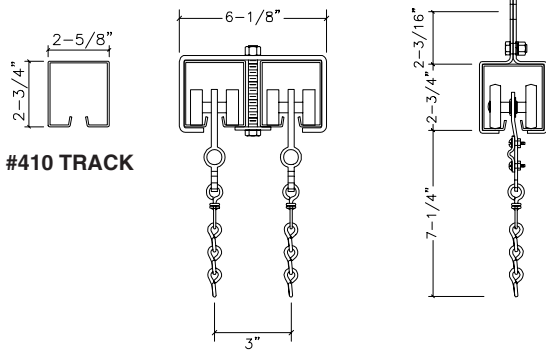

#410 TRACK

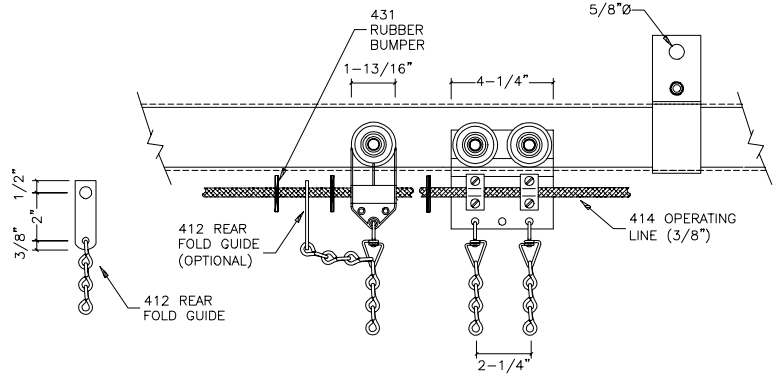

#418 SINGLE CARRIER AND #419 MASTER CARRIER

TRACKS AT CENTER OVERLAP

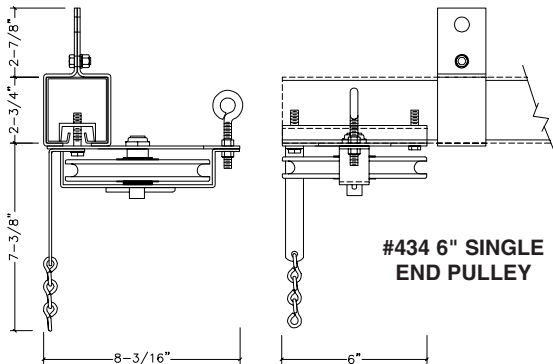

#434 6" SINGLE END PULLEY

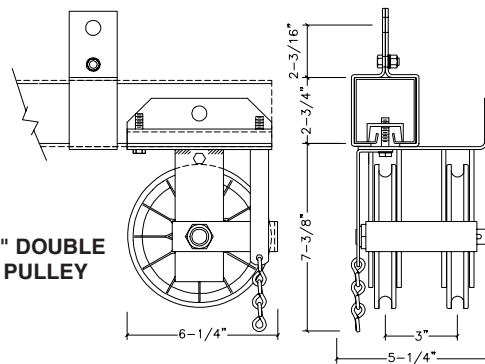

#433 6" DOUBLE END PULLEY

418P TRACK DIMENSION DETAIL

